



Grace Mountain

Main Level 2248
Lower Level 1470

Total 3718

Covered Porches 476
Open Decks 310
Garage 452

Number of Stories 1
Foundation Daylight Basement

Construction Type Timber Frame Hybrid
Enclosure Structural Insulated Panels (SIPs)

Style Craftsman, Mountain, Traditional

Bedrooms 3
Baths 2.5

House Dimensions

Width 64'8"
Depth 58'8"
Maximum Ridge Height 20'10"

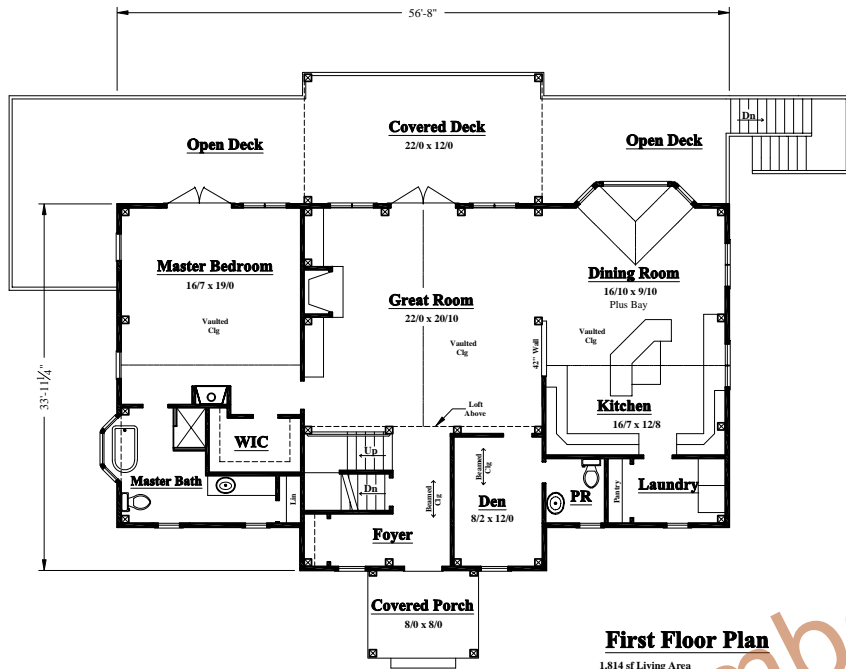

First Floor Plan
1,814 sf Living Area
240 sf Loft Area

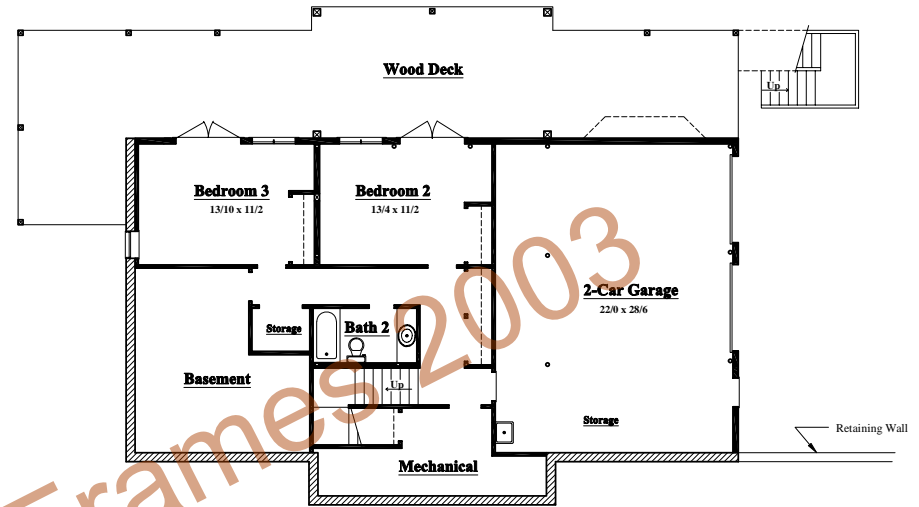

Lower Level Plan
667 sf Heated Living Area



Front Elevation



Rear Elevation

REVISIONS				
NO.	DATE	REMARKS	BY	

Copyright 2004 by Goshen Timber Frames, Inc.
All federal, state, and local codes, ordinance, regulations etc. shall be considered as part of specifications for this building and shall take precedence over anything shown, described, or implied where same are at variance. All dimensions and conditions shall be verified on site by builder.

GOSHEN
TIMBER FRAMES

37 PHILLIPS STREET
FRANKLIN, NC 28734

(828) 524-8662
timberframemag.com

Grace Mountain With Loft

SCALE: Noted
DATE: 1-10-05

FILE NO.:
DRAWN BY: MAW
SHEET NUMBER: 1 of 1

